

## **CONGRATULATIONS ON PURCHASING YOUR PRODUCT!**

Please read these instructions carefully. The instructions are an integral component of the product. Therefore, please store them and the packaging carefully in case questions arise in the future. Please always include these instructions when you are handing on the product to a third-party. Children should only assemble or use the product when they are under adult supervision.

## **TECHNICAL SPECIFICATIONS**

Maximum carrying capacity: 30 kg

## **WARNING NOTICES**

This product is only suitable for smooth paved surfaces. Do not use it on public roads. The product is only intended for use by one person. Please take care that your child wears appropriate protective gear (helmet) and shoes when using the product. Do not allow your child to use the bike at twilight, at night or in poor visibility. To prevent putting your child or others in danger, do not let it be used on roads or thoroughfares or on slopes or hills. Avoid using it in the proximity of stairs and open water. Inspect the product before each use to ensure that all parts are still fixed in place correctly and that the product is functioning as intended. The tires should only be inflated by adults. In doing so, make sure that the sealing cap is screwed on again as tightly as possible, so that it cannot be unscrewed by children. Keep the instruction sheet. Not suitable for children under 36 months due to small swallowable.

## **CONTENTS OF BOX**

1. Front wheel fork
2. Frame with back wheel
3. Handlebars
4. Front wheel
5. Saddle
6. Small parts
7. Instruction on assembly and use

OTHER PARTS INCLUDED IN THE DELIVERY ARE NOT REQUIRED FOR THE ASSEMBLY AND USE OF THE PRODUCT

## **ASSEMBLY INSTRUCTIONS**



1. Put the front wheel into the fork and tighten the nuts. Make sure the hooks in the lock washers are in their intended holes in the fork.



2. Push the fork from below through the frame, as shown in the diagram. Make sure there is a plastic ring above and below the frame.

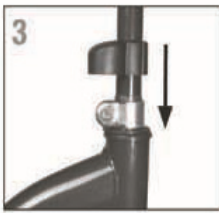

3. Push the covering cap over the handlebar rod. Then push the handlebar clamp onto the fork shaft from above. Make sure that the fork is fitting fully to the frame bushings. Push the handlebars into the fork shaft (take note of the marker indicating the minimum depth it should be stuck in) and bolt together the handlebar clamp. Make sure the handlebars are clamped in the centre and cannot be turned out of position.

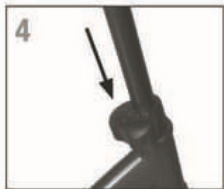

4. Push the covering cap over the handlebar clamp.



5. Stick the saddle into the seat post. Take note of the marker on the seat post indicating the minimum depth it should be stuck in. Adjust the saddle to the centre and tighten the clamp.

### **SETTING UP THE BAND BRAKE (if available)**

The brake system is pre-mounted in the factory and should be checked and adjusted if needed before the bicycle is put into use. If you find the brake action insufficient when checking the brakes, please turn the adjusting screw (a) a few times outwards and the brake pressure will increase. If required, the brake cable on the screw (b) can be set tighter by unscrewing the clamping nut and retightening the cable. Then tighten the clamping nut again. If this should still not suffice, you can adjust the brake pressure by adjusting both brake drum screws (c) in quarter turns.

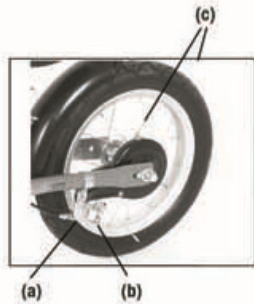

After each adjustment, check that the wheel can move freely as otherwise the brakes could get damaged.

### **IMPORTANT!**

After doing any work on the brakes please always check carefully to ensure that all screws have been tightened and are functioning correctly.

### **CARE AND MAINTENANCE**

Use a dry or damp cloth only to clean the product; do not use special cleaning agents! Check the product for damage or traces of wear and tear before and after each use. Store the product in a safe place where it is protected from the elements, cannot be damaged, and cannot injure anyone.

Not suitable for children under the age of 3. Contain small components which could be swallowed or inhaled by young children. Please retain this information. This product complies with EN-71. Wear during using a protective helmet.



CH. H. KUBBINGA., Parallelweg 25, 1131 DM Volendam, Nederland.

Mail: [info@kubbinga.nl](mailto:info@kubbinga.nl)

Website: [www.yipeeh.com](http://www.yipeeh.com)